

1979 Apache Solid State and Eagle Camping Trailers



S	M	T	W	T	F	S
				1	2	3
4	5	6	7	8	9	10
11	12	13	14	15	16	17
18	19	20	21	22	23	24
25	26	27	28	29	30	

When the weekends roll around, your Apache is ready to roll.

www.apacheowners.com

Eagle 169 Interior

Eagle 169 Inlets Conveniently Positioned Next to Doorway

Convenient Galley with Color-Matched Sink and Range, Storage Beneath

Eagle 130

Lightweight Eagle 130 Tows Easily with Subcompact

25-Foot Power Core

Eagle 169

www.apacheowners.com

The Apache Eagle:
The tough little softie
with weekend wings!

Thank goodness it's Friday!

Finally, the weekend's here. It's time to leave all the worries of work behind and get out for a little fun and relaxation with your family. And an Apache Eagle makes it so easy. Affordably priced and light as a breeze to tow (the smallest model, the Eagle 130, weighs only 510 pounds!), the Eagles are the perfect answer to skyrocketing prices and today's smaller cars. And with their low-road profile, the Eagles save even more money at the gas pump. So go ahead and get going. An Apache Eagle is ready to fly away with you. T.G.I.F.!

The Eagles' easy flight!

Once you're on your way you can almost forget you're towing an Eagle. Whether you're on the highway or off the beaten path it handles the road with confidence and ease. And once you get to where you're going your Eagle sets up in just minutes. Why waste time working when you should be playing? Grab your tackle! There's no missed fishing with an Apache Eagle.

Eagle comfort makes Thursdays a thing of the past!

For 1979 there are six Apache Eagle models to choose from, ranging in open lengths from 13 to 19 feet. Accommodations start with our lightweight all-tent Eagle 130 for the back-to-basics camper and progress upward to the pampering Eagle 192D with its solid insulated roof, full kitchen with three-burner range and sink, icebox, front and rear dinettes and soft, comfortable cushions. Plus all Eagles except the Model 130 come standard with zippered vinyl windows to keep out inclement weather. And when it comes to outstanding accessory features, there's a long list to choose from shown under specifications and options.

Apache Eagle Value: A feather in your cap.

Just one look and we're sure you'll agree that the Apache Eagles are an outstanding value. Lightweight, affordable and easy on gas, they're designed to provide you with years of

dependable service, weekend after weekend, vacation after vacation. So where are you going this weekend? Your Apache Eagle's waiting to fly away.

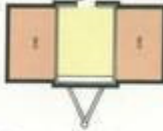

Eagle 130: For the back-to-basics camper with all tenting made of durable army duck. Easy towing thanks to a low road profile of only 41 inches and a curb weight of only 510 pounds. Plenty of room for personal gear. Two double beds, accent stripe and decal, and a one-piece undercoated floor are also standard. Sleeps four.

Eagle 130—Weight (approx.) 510 lbs²
• Length 9'3" • Width 5'1" • Road Height 3'5" • Tires 4.80/4.00 x 8" • Load Range "B"
• Height 7' • Width 6'3" • Length 13'0"^{***}
• Bed Dimensions 71" x 47"

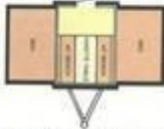

Eagle 130H: Lightweight design and the security of a one-piece insulated roof. Full dinette with soft cushions, spring-loaded assist lift system and one-piece undercoated floor are also standard. Tongue jack and wheel make setup and fix-ups a breeze.

Eagle 130H—Weight (approx.) 670 lbs²
• Length 9'3" • Width 5'5" • Road Height 3'8" • Tires 4.80/4.00 x 8" • Load Range "B"
• Living Area: Height 6'4" • Width 6'3" • Length 13'0"^{***} • Bed Dimensions 71" x 47"

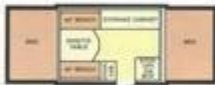

Eagle 169: Three separate storage areas mean plenty of room for clothes and personal items. Plus a convertible dinette, cushions, ceiling light and spring-loaded assist lift system for easy setup. The sturdy bumper, self-storing door and accent stripes add even more quality and good looks to your Eagle. Sleeps six.

Eagle 169—Weight (approx.) 985 lbs²
• Length 11'8" • Width 6'7" • Road Height 3'10" • Tires 16.5 x 6.5 x 8" • Load Range "C" • Living Area: Height 6'4" • Width 6'1" • Length 16'9" • Bed Dimensions 71" x 48"



Eagle 169K: Practical living with a rear dinette and a handsome kitchen with complete galley. Hand-operated water pump, 20-pound gas bottle, city water hookup and 110-v receptacle give you homelike comforts. Roof vent, self-storing door and fire extinguisher are also standard. Sleeps six.

Eagle 169K—Weight (approx.) 890 lbs²
• Length 11'8" • Width 6'7" • Road Height 3'10" • Tires 16.5 x 6.5 x 8" • Load Range "C" • Living Area: Height 6'4" • Width 6'1" • Length 16'9" • Bed Dimensions 71" x 48"



Eagle 192: Complete Eagle comfort with the added convenience of a wardrobe closet and extra storage space. Full kitchen includes range, sink, icebox, handy storage drawers and a roomy dinette. Ten-gallon water storage 110-volt receptacles and ceiling light are standard as well. Sleeps six.

Eagle 192—Weight (approx.) 1270 lbs²
• Length 14'6" • Width 6'7" • Road Height 4'3" • Tires 5.30 x 12" • Load Range "C" • Living Area: Height 6'4" • Width 6'2" • Length 19'2" • Bed Dimensions 71" x 54"



Eagle 192D: The most luxurious Eagle. Full kitchen with three-burner range, sink, icebox, front and rear dinettes and comfortable cushions throughout. Convenient roof vent, city water hookup and easy crank lift system are also included. Sleeps eight.

Eagle 192D—Weight (approx.) 1240 lbs²
• Length 14'6" • Width 6'7" • Road Height 4'3" • Tires 5.30 x 12" • Load Range "C" • Living Area: Height 6'4" • Width 6'2" • Length 19'2" • Bed Dimensions 71" x 54"

²Does not include accessories, gas or water.
^{***}Open width—beds open to sides.

www.apacheowners.com

6 Amp—12/20V Converter

Consistent Drain Outlets Under Chassis

Consistent Interior with Storage Door

Locking Outside Access Storage Door (Optional)

Built-In Storage Drawers

Self-Storing 25-Foot 110V Power Cord

Exclusive Epicyclic Lift System

FingerTip Cabinet Pull Hardware

Ceiling Vent and Light

Color-Matched Range and Sink

Solid-Backed Cushions Throughout

Sliding Tinted Picture Windows

www.apacheowners.com

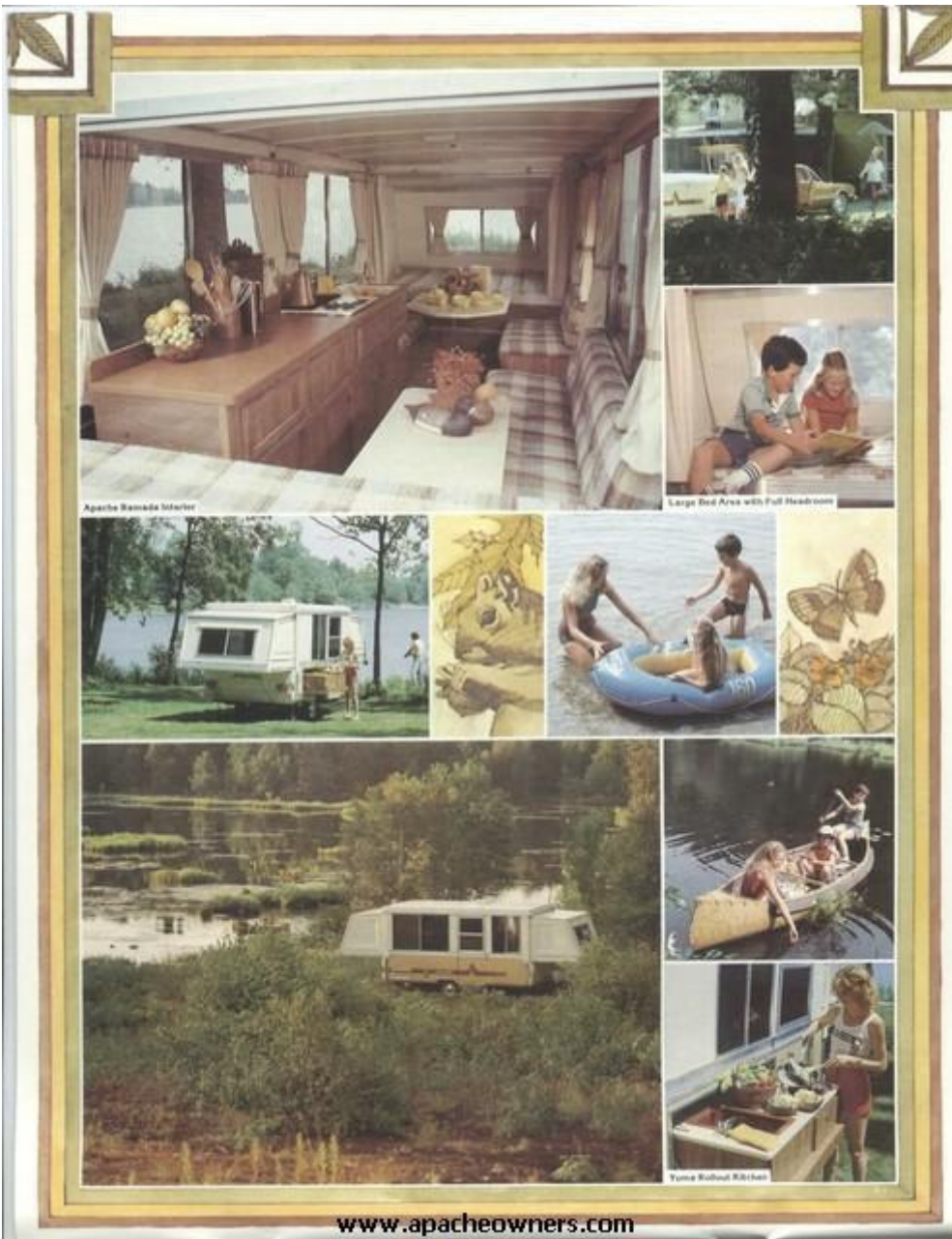



Cimarron—The Cimarron features a carpeted lounge area with two deluxe padded/upholstered barrel chairs and a drop-leaf center table. A full kitchen with icebox and convertible side gauchó are also included for ease and comfort. Overhead roof vent keeps the air fresh and clean. Sleeps six.

Cimarron—Weight (approx.) 1930 lbs*
 • Length 16'6" • Width 6'7" • Road Height 4'6" • Tires 20.5 x 8" x 10" Load Range "C" • Living Area Height 6'2" • Width 6'5" • Length 20'7" • Bed Dimensions 72" x 54"



Roamer—Luxury living with a shower, hot water heater and electric water pump. Complete kitchen and convertible dinette as well. The Roamer also includes comfort items like deluxe upholstered cushions and two ceiling lights. Sleeps six.

Roamer—Weight (approx.) 1950 lbs*
 • Length 16'6" • Width 6'7" • Road Height 4'6" • Tires 20.5 x 8" x 10" Load Range "C" • Living Area Height 6'2" • Width 6'5" • Length 20'7" • Bed Dimensions 72" x 54"



Ranger—Combines comfort and practicality. Allows total freedom of movement front to rear. Convertible side dinette has a special table extension for added convenience. Full kitchen includes complete galley, storage drawers and icebox which is conveniently located next to outside door for greater accessibility.

Ranger—Weight (approx.) 1760 lbs*
 • Length 14'10" • Width 6'7" • Road Height 4'6" • Tires 20.5 x 8" x 10" Load Range "C" • Living Area Height 6'2" • Width 6'5" • Length 18'6" • Bed Dimensions 72" x 54" and 72" x 48"

In addition to other standard features, all Silver Line Apache Solid State models include:

- Self-storing rear leveling jacks
- Roof vent
- 110-volt duplex receptacles
- 12-volt ceiling light
- Washable double-knit draperies
- Icebox (except Yuma)
- Upholstered cushions
- 20-lb. gas bottle regulator and hookup (except Yuma)
- 10-gallon water storage tank (except Yuma)
- 25-foot power cord
- Sink cover
- Vinyl floor covering
- Tongue jack and wheel
- Safety chains
- Fire extinguisher (except Yuma)



Royal—Complete kitchen with full galley, icebox, storage drawer and a convertible rear dinette. Plus, two extra storage areas and a handy wardrobe closet for hanging clothes and personal items. Other standard extras include, a 20-pound gas bottle and city water hookup. Sleeps six.

Royal—Weight (approx.) 1650 lbs*
 • Length 14'10" • Width 6'7" • Road Height 4'8" • Tires 5.30 x 12" Load Range "C" • Living Area Height 6'2" • Width 6'5" • Length 18'0" • Bed Dimensions 72" x 48"



Mesa—Solid State quality in a compact size. The Mesa sleeps six when rear dinette is converted to a bed. The full galley includes range with color-matched sink, icebox and storage drawers. A convenient ceiling light and roof vent are also standard.

Mesa—Weight (approx.) 1480 lbs*
 • Length 13'5" • Width 6'7" • Road Height 4'8" • Tires 5.30 x 12" Load Range "C" • Living Area Height 6'2" • Width 6'5" • Length 16'1" • Bed Dimensions 72" x 48"



Yuma I—The Yuma I features a roll-out kitchen complete with two-burner range, color-matched sink and hand-operated water pump for indoor/outdoor cooking. Extra room allows for optional portable toilet enclosure. Icebox, storage drawers and city water hookup are also included. Sleeps up to six comfortably with convertible side dinette.

Yuma I—Weight (approx.) 1500 lbs*
 • Length 13'5" • Width 6'7" • Road Height 4'8" • Tires 5.30 x 12" Load Range "C" • Living Area Height 6'2" • Width 6'5" • Length 16'1" • Bed Dimensions 72" x 48"

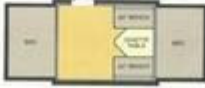

Yuma—The basic Solid State model is perfect for people who prefer using their own gear. Two double beds, a convertible dinette, washable double-knit curtains all around and plenty of storage space are all standard. A ceiling light, roof vent, and tongue jack and wheel are also included for additional convenience.

Yuma—Weight (approx.) 1330 lbs*
 • Length 13'5" • Width 6'7" • Road Height 4'8" • Tires 5.30 x 12" Load Range "C" • Living Area Height 6'2" • Width 6'5" • Length 16'1" • Bed Dimensions 72" x 48"

*Does not include accessories, gas or water

www.apacheowners.com

Apache Accessories



Thermostatically Controlled 16,000 BTU Ducted Forced Air Furnace



Screen Room with Canopy



12V Electric Power Lift



Hydraulic Surge Brakes



Privacy Curtains

- Axle w/Electric Brakes
- Axle w/Hydraulic Surge Brakes
- 110-12V Electric/Gas Refrigerator
- 16,000 BTU Furnace w/Blower
- 12,000 BTU Furnace w/Blower
- Spare Tire & Wheel
- 110-12V Converter
- Outside Access Door
- Outside 110V Receptacle with GFCI
- Wheel Discs
- Entrance Step
- Spare Tire Mount*
- Spare Tire Cover
- Portable Toilet
- Canopies
- Side Wall, Draperies
- Add-a-Room (Canopy Required)
- Screen Room (Canopy Required)
- Privacy Curtains
- Rear Bumper
- Power Lift
- Outside Table Mount
- Double Gas Bottle Assembly

	Compton	Remade	Ranger	Royal	Alta	Yuma 1	Yuma	Yuma	Eagle 130	Eagle 130H	Eagle 100K	Eagle 100	Eagle 112	Eagle 120D
Axle w/Electric Brakes	S	S	S	S	O	O	O	O	O	N	N	N	N	N
Axle w/Hydraulic Surge Brakes	S	S	S	S	O	O	O	O	O	N	N	N	N	N
110-12V Electric/Gas Refrigerator	N	N	N	N	N	N	N	N	N	N	N	N	N	N
16,000 BTU Furnace w/Blower	O	O	O	O	O	O	O	O	O	O	O	O	O	O
12,000 BTU Furnace w/Blower	N	N	N	N	N	N	N	N	N	N	N	N	N	N
Spare Tire & Wheel	S	S	S	S	O	O	O	O	O	O	O	O	O	O
110-12V Converter	S	S	S	S	O	O	O	O	O	O	O	O	O	O
Outside Access Door	O	O	O	O	O	O	O	O	O	O	O	O	O	O
Outside 110V Receptacle with GFCI	O	O	O	O	O	O	O	O	O	O	O	O	O	O
Wheel Discs	S	S	S	S	O	O	O	O	O	O	O	O	O	O
Entrance Step	O	O	O	O	O	O	O	O	O	O	O	O	O	O
Spare Tire Mount*	O	O	O	O	O	O	O	O	O	O	O	O	O	O
Spare Tire Cover	O	O	O	O	O	O	O	O	O	O	O	O	O	O
Portable Toilet	O	O	O	O	O	O	O	O	O	O	O	O	O	O
Canopies	O	O	O	O	O	O	O	O	O	O	O	O	O	O
Side Wall, Draperies	O	O	O	O	O	O	O	O	O	O	O	O	O	O
Add-a-Room (Canopy Required)	O	O	O	O	O	O	O	O	O	O	O	O	O	O
Screen Room (Canopy Required)	O	O	O	O	O	O	O	O	O	O	O	O	O	O
Privacy Curtains	O	O	O	O	O	O	O	O	O	O	O	O	O	O
Rear Bumper	O	O	O	O	O	O	O	O	O	O	O	O	O	O
Power Lift	O	O	O	O	O	O	O	O	O	O	O	O	O	O
Outside Table Mount	O	O	O	O	O	O	O	O	O	O	O	O	O	O
Double Gas Bottle Assembly	O	O	O	O	O	O	O	O	O	O	O	O	O	O

*Requires Bumper on Some Models
 S--Standard O--Optional N--Not Available

VESELY COMPANY
 The Vesely Company reserves the right to make changes at any time without notice in prices, colors, materials, equipment, applications and models, and to discontinue models or make changes without obligation regarding previous models. Some items shown in product illustrations are extra-cost accessories. Vesely Company, Box 310, Lapeer, Michigan 49750.



Made in U.S.A.

www.apacheowners.com